

HYDROCARBON SEPARATOR CE 5 MG/L V100 SLUDGE TRAP WITHOUT BYPASS CIRCULAR PRIMER POLYESTER

6658

1 Technical definition

An oil separator is designed to separate and store free hydrocarbons contained in runoff water.

These hydrocarbon separators without by-pass are equipped with a silt storage, allowing to trap suspended matters (sands, gravels). They are perfectly suitable to treat water coming from covered parking lots, petrol stations, garages. For washing areas, provide an additional V200 silt storage in order to obtain a V300 volume.

Reminder the hydrocarbon level alarm is mandatory as additional equipment unless exempted by the local authorities.

2 Maintenance

An annual inspection must be performed to verify the operation of the device.

It is recommended to empty the unit when the sludge reaches 50% of the useful volume of the sludge trap or when the hydrocarbons fill 80% of the retention capacity of the separator (see NF P16-442).

After each draining, the unit must be put back in water and the obturator must be checked for leaks.

General maintenance instructions E114 available on our website.

3 Advantages

- design according to NF EN 858-1 and NF EN 858-2
- tank guaranteed 10 years against corrosion
- resistance in saline environment
- resistance to groundwater up to mid-tank height (beyond that, please consult us)
- low weight
- easy to handle
- removable coalescence for easy maintenance
- easy to connect

5 Handling - installation

Refer to the PHPRV-NC manual before handling and installing the separator.

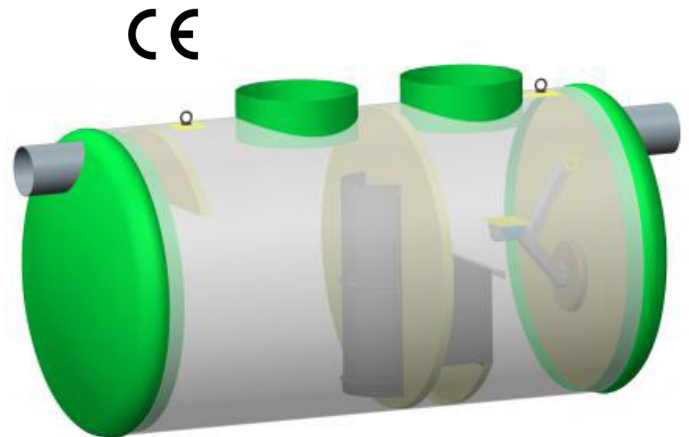

4 Operation

The operation of the hydrocarbon separator is based on the separation by density difference of the non-soluble liquids (density 0.85) contained in the runoff water.

The silt storage compartment allows settling and trapping of suspended solids > 200 µm.

The coalescing system, thanks to its specific surface important, makes it possible to concentrate the free hydrocarbons by promoting their collision. The hydrocarbons then rise to the surface.

The automatic shutter (float) avoids any risk the release of hydrocarbons.

HYDROCARBON SEPARATOR CE 5 MG/L V100 SLUDGE TRAP WITHOUT BYPASS CIRCULAR PRIMER POLYESTER

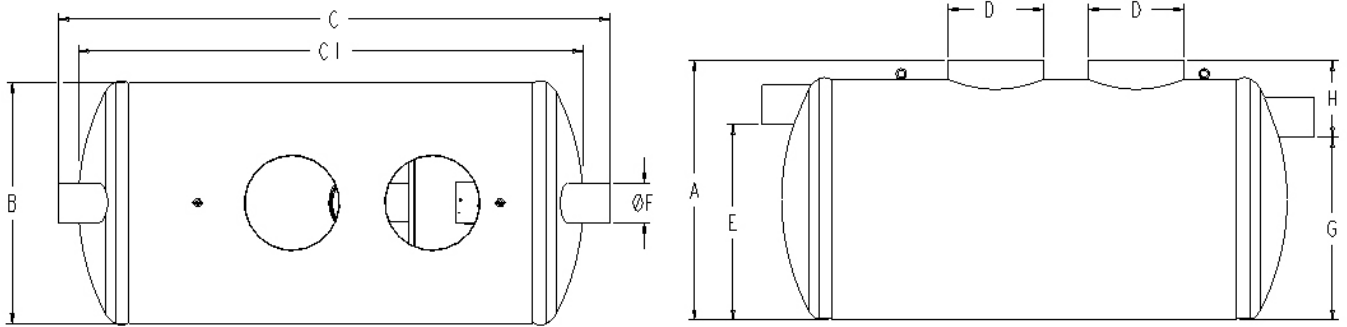

Reference	Flow rate treated (in l/s)	Number of primers	A	B	C1	C	D	E	ØF	G	H	Volume of the silt storage	Retention volume for light liquids	Weight
SH3/6658/35	35	2	1760	1600	4106	4583	600	1258	315	1158	603	3500 L	600 L	445 Kg
SH3/6658/40	40	2	1760	1600	4431	4908	600	1258	315	1158	603	4000 L	615L	460 Kg
SH3/6658/50	50	2	2060	1900	4017	4387	750	1559	315	1459	603	5000 L	606 L	578 Kg
SH3/6658/60	60	2	2050	1900	5012	5412	750	1515	315	1415	635	6000 L	740 L	805 Kg
SH3/6658/70	70	2	2050	1900	5512	5912	750	1515	315	1415	635	7000 L	760 L	862 Kg
SH3/6658/80	80	2	2050	1900	5912	6312	750	1515	315	1415	635	8000 L	800 L	907 Kg
SH3/6658/90	90	2	2050	1900	6712	7112	750	1515	315	1415	635	9000 L	900 L	997 Kg
SH3/6658/100	100	2	2050	1900	7412	7812	750	1515	315	1415	635	10000 L	1000 L	1106 Kg
SH3/6658/110	110	2	2450	2300	5720	6120	750	1830	400	1730	720	11000 L	1195 L	1052 Kg
SH3/6658/120	120	2	2450	2300	6020	6420	750	1830	400	1730	720	12000 L	1200 L	1094 Kg
SH3/6658/130	130	2	2450	2300	6520	6920	750	1830	400	1730	720	13000 L	1300 L	1163 Kg
SH3/6658/140	140	2	2450	2300	7020	7420	750	1830	400	1730	720	14000 L	1404 L	1270 Kg
SH3/6658/150	150	2	2450	2300	7420	7820	750	1830	400	1730	720	15000 L	1500 L	1338 Kg
SH3/6658/160	160	2	2450	2300	7920	8320	750	1830	400	1730	720	16000 L	1600 L	1407 Kg
SH3/6658/170	170	2	2450	2300	8420	8820	750	1830	400	1730	720	17000 L	1700 L	1476 Kg
SH3/6658/180	180	2	2450	2300	8920	9320	750	1830	400	1730	720	18000 L	1800 L	1545 Kg
SH3/6658/190	190	2	2450	2300	9320	9720	750	1830	400	1730	720	19000 L	1900 L	1600 Kg
SH3/6658/200	200	2	2450	2300	9820	10220	750	1830	400	1730	720	20000 L	2000 L	1669 Kg

Options :

ANH22/14310-N : Visual and audible hydrocarbon alarm with 220V power supply (only 1 hydrocarbon sensor possible)

ANH22/14320 : Visual and audible hydrocarbon alarm with 220 V power supply (3 probes possible)

ANH22/14506 : Hydrocarbon alarm with solar panel power supply (connection of up to 6 probes installed on 2 different separators)

SNB/14220 : Sludge Level Sensor

KEC3/19 : Ladder fixed on manhole

KOPRV/1600B: Sludge extraction for Ø1600 tank

KOPRV/1900B: Sludge extraction for Ø1900 tank

CA3/6394/IOT : Anchoring belt 10 tons and WINCH length 10 m.